

COMPUTER CASES *by*

OLSON

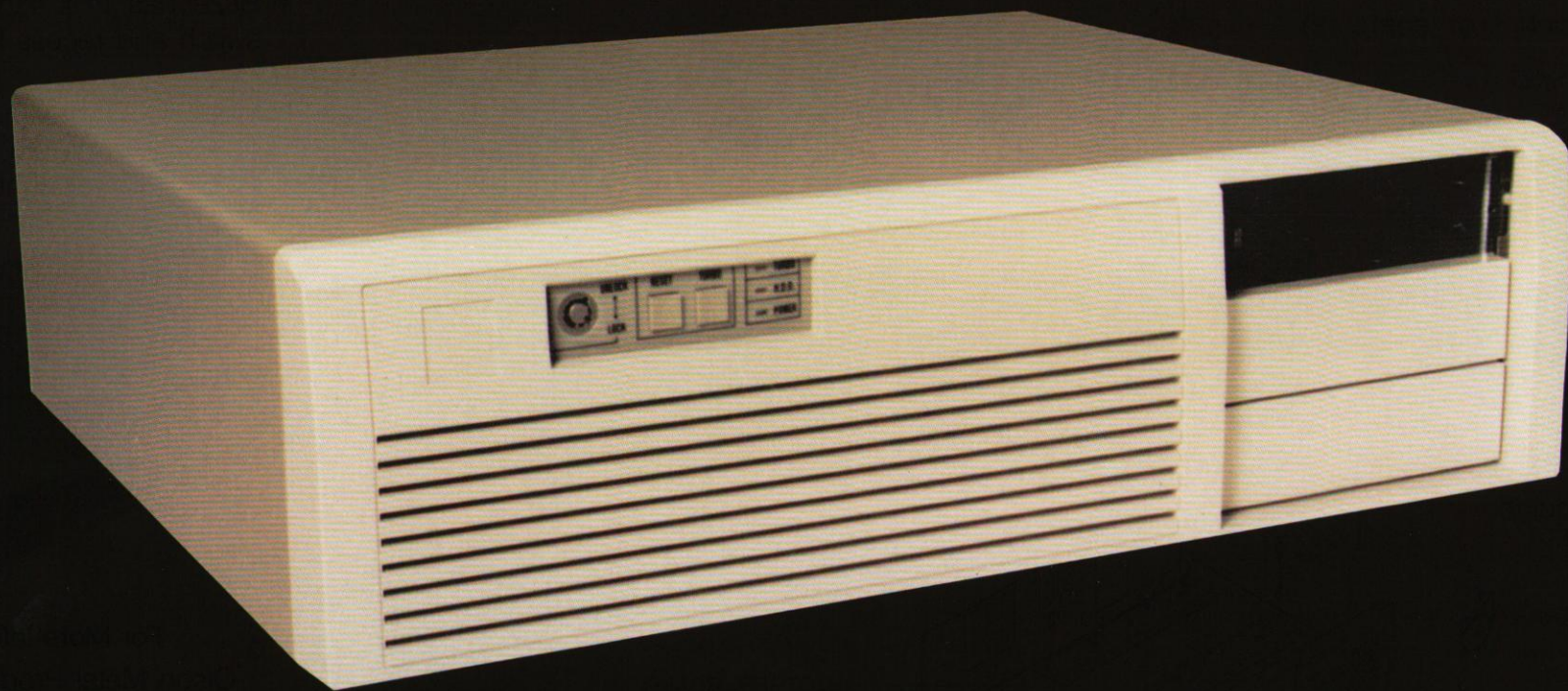

- *Full Size Desktop*
- *Five Bays*
- *EMI Tested*
- *Designed for 12 mHz & above*
- *Hardware Included*



MADE IN

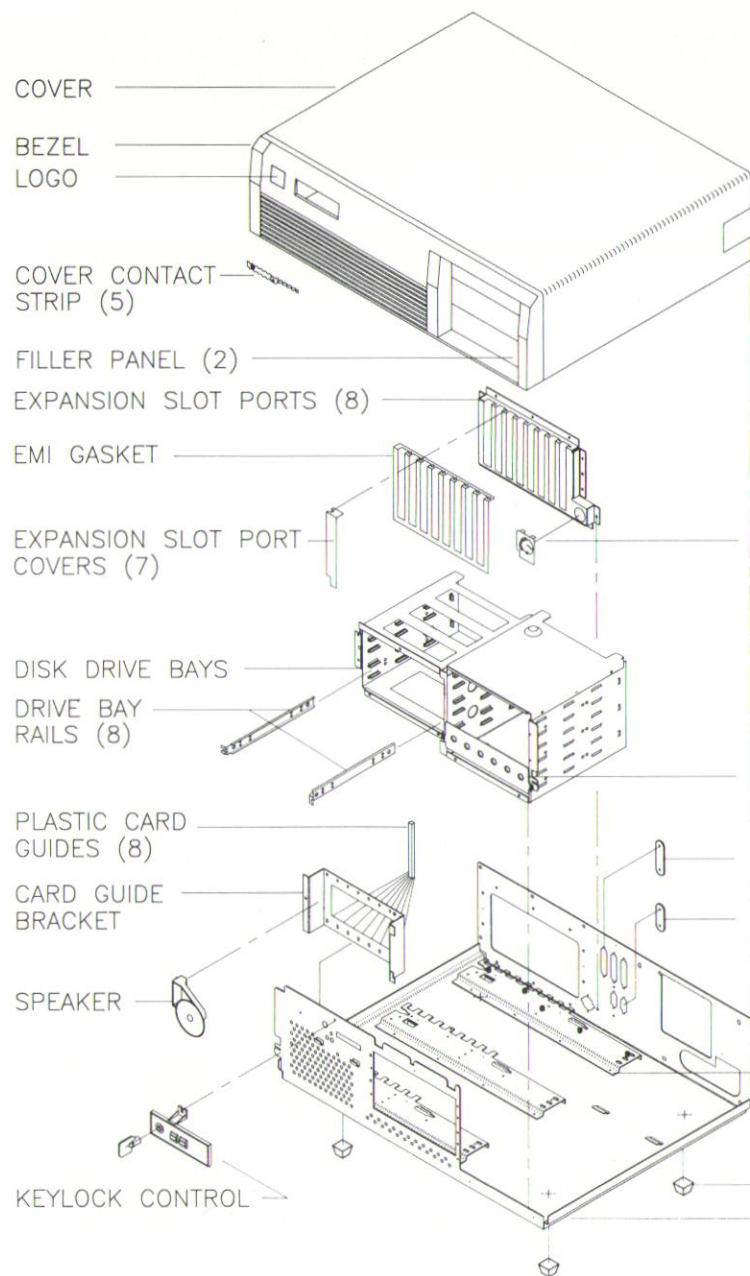

MISC HARDWARE:

NYLON "C" CLIP (3)
 3MM X .5 PITCH SCREW (12)
 6-32 X .25 PHILLIPS FLAT #4 (8)
 METAL STANDOFF (2)
 PLASTIC STANDOFF (3)
 PLASTIC LOCKING CLIP (1)
 6-32 X .25 HPW-MS (23)

FEATURES

- Best fit and finish in the industry.
- Consistency of dimensions that only permanent tooling can produce.
- Compatible with a variety of mother boards.
- Strong 18 gauge electro galvanized steel.
- Five half-height bays, three open to front.
- Bezel has 1" x 4" window for lock and switch and recess for logo.

DIMENSIONS: Depth - 16 3/4"
 Width - 21 1/8"
 Height - 6 1/2"

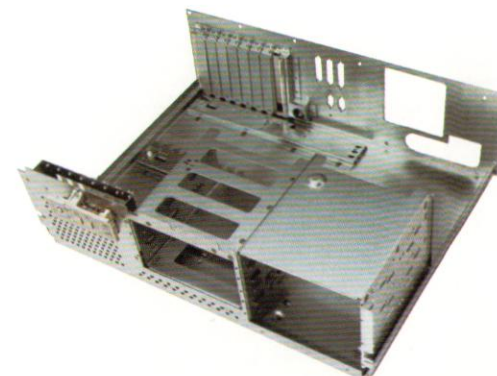

For More Information:

Olson Metal Products Company
 Crossroads Industrial Center
 Seguin, Texas 78155
 512-379-2799 FAX 512-379-4921

Or

COMPUTER CASES *by*

OLSON



- Small Footprint
- Low Profile
- Modular FDD Support
- Custom Logo Insert
- Riser Card Included

- Slide-Lock Cover - No Screws on Sides*
- EMI Tested - Shielding System Built-in*

* Patent Applied For

MADE IN



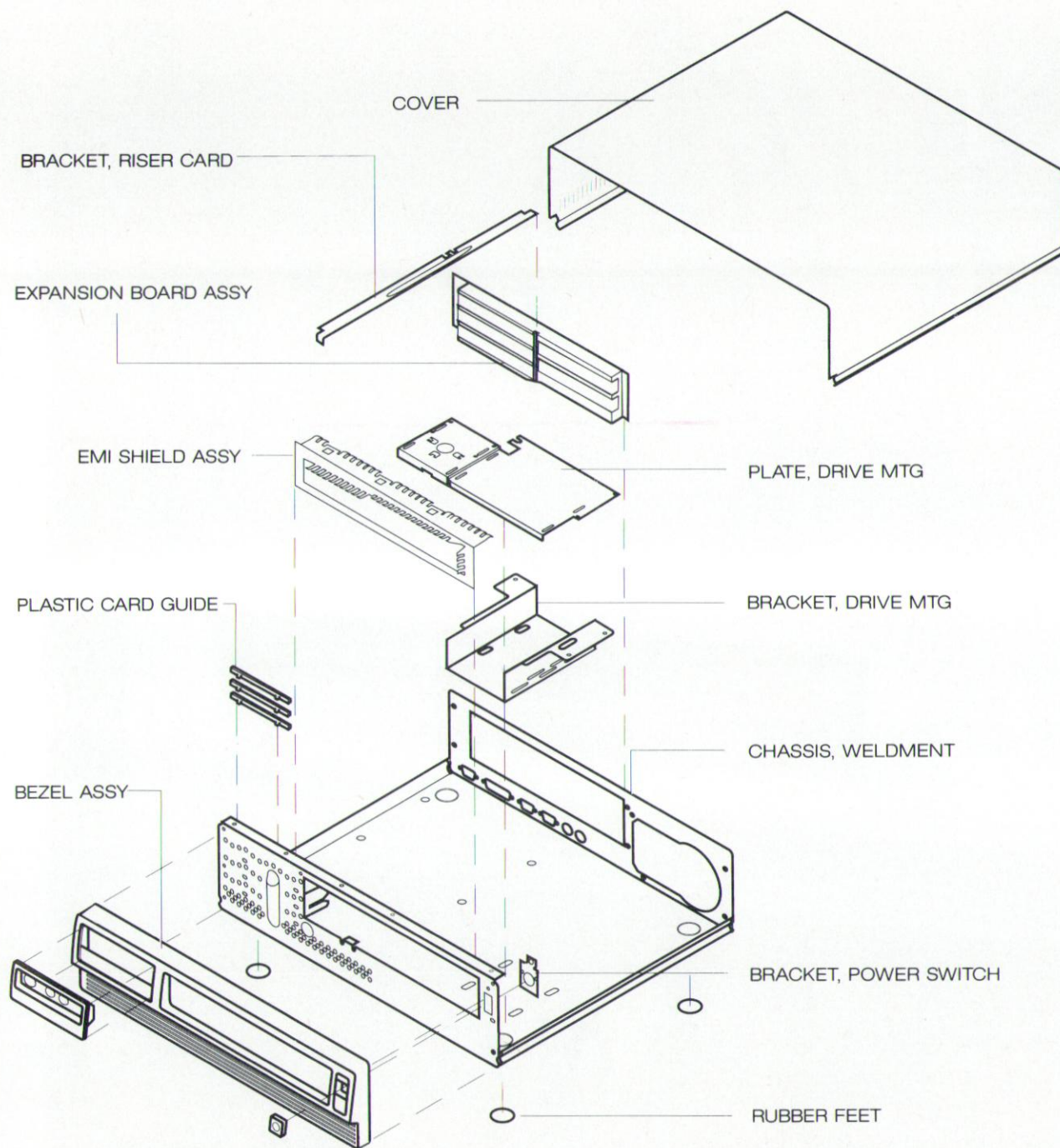

FEATURES

- EMI shielding and grounding tabs are integral to the case designed to meet FCC CLASS B.
- Accepts motherboards similar to WDC LPX/LPM form factor or Baby AT/XT sizes.
- Riser Card furnished - takes 3 full length and 2 half length boards. 5 slot backplane.
- Drive mounting plate provides modular type installation of FDD units.
- Slide-On-Cover — no side screws, slide-lock groove provides EMI seal along sides.
- Drives: 1-3.5" and 1-5.25" FDD. 1-3.5 HDD - (Internal).
- CUSTOM LOGO can be molded into front bezel insert.
- Patent Pending

KEY DIMENSIONS:	DEPTH	WIDTH	HEIGHT
OVERALL ASSEMBLY	15.5"	16.3"	4.3"
CHASSIS	14.3"	16.3"	4.3"
BEZEL	1.5"	16.3"	3.9"

For More Information:

Olson Metal Products Company

Crossroads Industrial Center

Seguin, Texas 78155

512-379-7000 FAX 512-379-7197

Or

